



Senju Sprinkler

2" SPRINKLER PRESSURE GAUGE with 1/4" NPT Lower Mount

- Designed for general purpose
- A wide variety of applications including plumbing, compressors and other equipment
- Ideal for use in residential sprinkler systems
- Weather and rust resistant

SPECIFICATIONS

Size:
2.0" (48.8mm)

Accuracy:
± 2.5% (Grade B ANSI B40.1)

Range:
0-300 psi, Water

Bourdon Tube:
Copper Alloy
C-type

Connection:
Copper Alloy
1/4" NPT Lower Mount (LM)

Window:
Snap-On Plastic

Pointer:
Aluminum
Painted Black

Movement:
Copper Alloy

Dial:
Aluminum
White Background with Black and Red Lettering

Case:
Black ABS

Operating Temperature:
Ambient: -4°F to 140°F (-20°C to 60°C)
Media: Max 158°F (70°C)

*Specifications are subject to change without notice

DIMENSIONS & WEIGHT

Size	A* mm (Inch)	B mm (Inch)	C mm (Inch)	E mm (Inch)	W mm (Inch)	Weight g (lbs.)
2"	48.8 (1.92)	45.6 (1.80)	26.9 (1.06)	9.6 (0.38)	14.0 (0.55)	86 (0.19)

* Nominal Size

T: 1/4" NPT

Part Number: 90000-130-0301

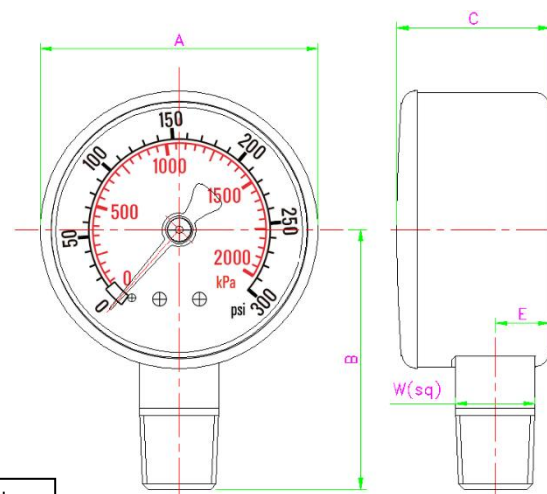

WARNING: Cancer and Reproductive Harm
www.p65warnings.ca.gov